

Sullivan Palatek®

Dedicated to Quality....

....Committed to Support

Designed as a medium to heavy duty construction drill suitable for drilling medium hard rock.



- Forged alloy construction
- Adjustable drilling speeds
- Replaceable chuck, 1" x 4 1/4" or 7/8" x 4 1/4" or 7/8" x 3 1/4"
- Requires constant feed inline oiler or has internal oiler
- Optional muffler
- Optional Wet Kit available
- One year Warranty
- Manufactured in USA

Specifications		
Net Weight	51 lbs	23 kg
Length	20.5 in	521 mm
Bore	3 in	76 mm
Stroke	2 in	51 mm
Blows per minute	2300	2300
RPM	180	180
Chuck Sizes	1 x 4 1/4 in	25 x 108 mm
	7/8 x 4 1/4 in	22 x 108 mm
	7/8 x 3 1/4 in	22 x 83 mm
Air Inlet (NPT)	3/4 in	19 mm
Air Consumption*	92.2 cfm	2.6 m ³ /m
Water consumption		6.7l/m
Performance	24.4"/m	62 cm/m
in Granite at (6-7bar)85-90psi		*estimated

WHEN ORDERING TOOLS SPECIFY CHUCK SIZE

WHEN ORDERING REPLACEMENT PARTS, FURNISH THE MODEL NUMBER(S) AND SERIAL NUMBER(S) OF YOUR TOOLS.

FOR OPTIMUM PERFORMANCE, DO NOT OPERATE TOOL ABOVE 90 PSI (6 BAR) WORKING PRESSURE.

WARNING:

ALWAYS DISCONNECT THE AIR SUPPLY BEFORE CHANGING BITS OR DISMANTLING THE TOOL FOR SERVICE OR REPAIR. FOR MAXIMUM SAFETY WE ADVISE THE INSTALLATION OF A SHUT-OFF VALVE AT THE END OF THE AIR LINE.

DO NOT EXCEED 100 PSI (7BAR) WORKING PRESSURE.

PARTS LIST ROCK DRILL 50 lb class SRD-50

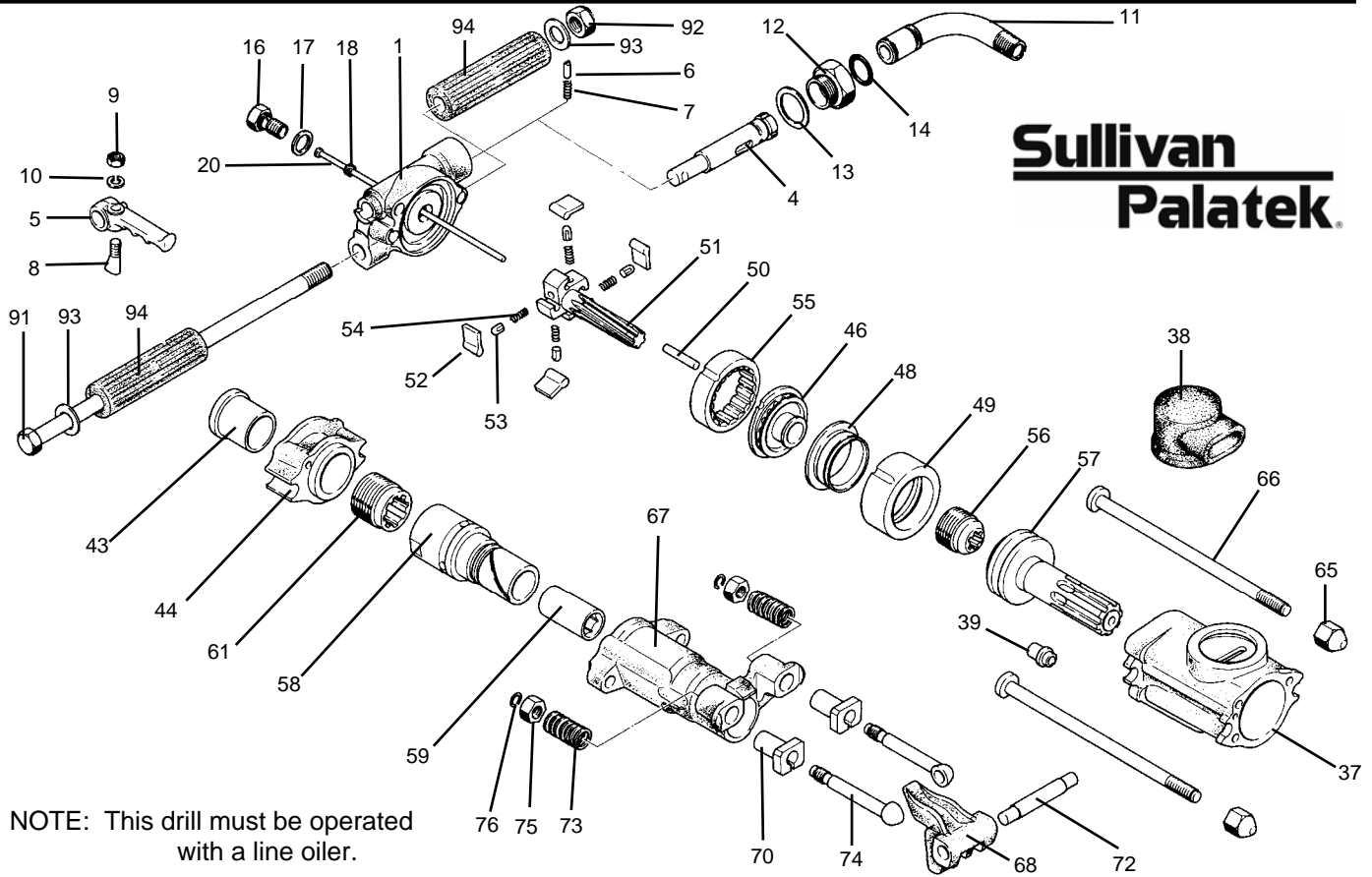

NOTE: This drill must be operated with a line oiler.

INDEX	PART	DESCRIPTION	INDEX	PART	DESCRIPTION
1	SI7339	BACKHEAD ASSEMBLY	54	SI7296	PAWL SPRING (4)
4	SI7360	THROTTLE VALVE	55	SI7357	RATCHET RING
5	SI7359	THROTTLE VALVE HANDLE	56	SI7345	RIFLE NUT
6	SI7361	THROTTLE VALVE PLUNGER	57	SI7351	PISTON
7	SI7362	THROTTLE VALVE SPRING	58	SI7349	ROTATION SLEEVE 1" x 4 1/4"
8	SI7258	THROTTLE VALVE BOLT		SI7348	ROTATION SLEEVE 7/8" x 3 1/4"
9	SI7260	THROTTLE BOLT NUT	59	SI7353	SLEEVE BUSHING 1"HEX x 4 1/4"
10	SI7259	THROTTLE BOLT LOCK WASHER		SI7371	SLEEVE BUSHING 7/8"HEX x 4 1/4"
11	SI7256	AIR CONNECTION SWIVEL		SI7352	SLEEVE BUSHING 7/8"HEX x 3 1/4"
12	SI7254	AIR CONNECTION NUT	61	SI7350	SLEEVE NUT
13	SI7252	AIR CONNECTION NUT WASHER	65	SI7308	SIDE ROD NUT (2)
14	SI7255	AIR CONNECTION O-RING	66	SI7367	SIDE ROD (2)
16	SI7337	BLOW TUBE GLAND	67	SI7355	FRONTHEAD 1" x 4 1/4" SHANK
NS	SI7337W	WATER TUBE GLAND		SI7354	FRONTHEAD 7/8" x 3 1/4" SHANK
17	SI7336	TUBE GLAND GASKET	68	SI7366	STEEL RETAINER 1" x 4 1/4"
18	SI7338	BLOW TUBE GASKET		SI7366A	STEEL RETAINER 7/8" x 4 1/4"
20	SI7356	BLOW TUBE		SI7365	STEEL RETAINER 7/8" x 3 1/4"
NS	SI7356W	WATER TUBE	70	SI7363	FRONTHEAD BUSHING (2)
37	SI7344	CYLINDER	72	SI7364	STEEL RETAINER PIN
38	SI7368	EXHAUST DEFLECTOR	73	SI7314	STEEL RETAINER SPRING (2)
39	SI7358	BLOWING CONNECTION	74	SI7313	STEEL RETAINER BOLT (2)
43	SI7347	FRONT WASHER BUSHING	75	SI7316	RETAINER BOLT NUT (2)
44	SI7346	FRONT WASHER	76	SI7312	RETAINER BOLT LOCK CLIP(2)
46	SI7341	VALVE CHEST COVER	91	SI7266	HANDLE BOLT
48	SI7343	AUTOMATIC VALVE	92	SI7270	HANDLE BOLT NUT
49	SI7342	VALVE CHEST	93	SI7269	HANDLE BOLT WASHER (2)
50	SI7299	VALVE DOWEL PIN	94	SI7268	HANDLE GRIP (2)
51	SI7340	RIFLE BAR	NS	SI6966	WATER VALVE
52	SI7298	ROTATION PAWL (4)	NS	SI7334	UNIVERSAL WATER CONNECTION GROUP (INCLUDES 6966)
53	SI7297	PAWL PLUNGER (4)			